

RIVERWALK CROSSING

400 - 1100 Riverwalk | Jenks, OK 74037



RETAIL SPACE AVAILABLE

BUILDING 300

2,664 SF RETAIL
SUITE 260

BUILDING 500

1,401 SF RETAIL
SUITE 150

1,401 SF RETAIL
SUITE 155

BUILDING 400

1,921 SF RETAIL
SUITE 120

3,037 SF RETAIL
SUITE 130

2,820 SF RETAIL
SUITE 160
BASE \$16.00 + NNN

OFFICE SPACE AVAILABLE

BUILDING 1000

11,292 SF OFFICE
SUITE 100

3,625 SF OFFICE
SUITE 240

1,410 SF OFFICE
SUITE 260
BASE \$14.00 + NNN

BUILDING 1100

5,135 SF OFFICE
SUITE 250

1,300 Parking On-Site

After Hours Security

Local On-Site Management

Prime Location at Jenks Riverwalk District

Daytime Population (3miles)

Trade Area: 22,851

OVERVIEW

FOR MORE INFORMATION:

Matt Mardis
Principal, Paine & Associates
918-481-5380 ext.13
matt@paine-associates.com

Garrett Mahoney
Partner, Paine & Associates
918-481-5380 ext.11
garrett@paine-associates.com

Brian Paine
Principal, Paine & Associates
918-481-5380 ext.12
brian@paine-associates.com



PAINE

COMMERCIAL REAL ESTATE

paine-associates.com

RIVERWALK CROSSING

400 - 1100 Riverwalk | Jenks, OK 74037

ABOUT

Located in the heart of The River District, Riverwalk Crossing is South Tulsa's first major lifestyle center and inaugural riverfront development.

Situated on the west bank of the Arkansas River, this mixed-use hub connects to the:

- highly anticipated Simon Outlet Mall (Spring 2021)
- Oklahoma Aquarium,
- Tulsa Riverparks Trail System,
- Jenks High School,

Jenks is a thriving business community.

Jenks boasts an excellent tax base, outstanding school district, quality homes, redeveloped River front, and is a prime location within the Tulsa metropolitan area.

Companies including:

- Kimberly Clark,
- Green Country Energy,
- Tulsa Winch and Cogentrix;

make Jenks a great place to live, work and do business.

Jenks is named the "Antique Capital of Oklahoma."

Enjoy visiting the historic charm of downtown Jenks with its wonderful brick architecture and its bustling antique and arts district.

JENKS DEMOGRAPHICS

Population (2019)	96th Street	Creek Top	Riverside Dr.
5 Minutes	14,416	9,754	19,085
10 Minutes	102,942	124,532	128,075
15 Minutes	298,751	337,045	331,809
Average HH Income (2019)			
5 Minutes	\$83,034	\$108,336	\$93,285
10 Minutes	\$98,869	\$100,897	\$97,018
15 Minutes	\$88,208	\$84,361	\$87,421
Age (2019)			
Average Age	39 yrs. old		
Traffic Counts (2017)			
	18,800	35,200	30,900

A GLANCE AT JENKS

"Jenks is one of America's Best Places to Live" by Money Magazine.

FOR MORE INFORMATION:

Matt Mardis
Principal, Paine & Associates
918-481-5380 ext.13
matt@paine-associates.com

Garrett Mahoney
Partner, Paine & Associates
918-481-5380 ext.11
garrett@paine-associates.com

Brian Paine
Principal, Paine & Associates
918-481-5380 ext.12
brian@paine-associates.com



PAINE

COMMERCIAL REAL ESTATE

paine-associates.com

RIVERWALK CROSSING

400 - 1100 Riverwalk | Jenks, OK 74037

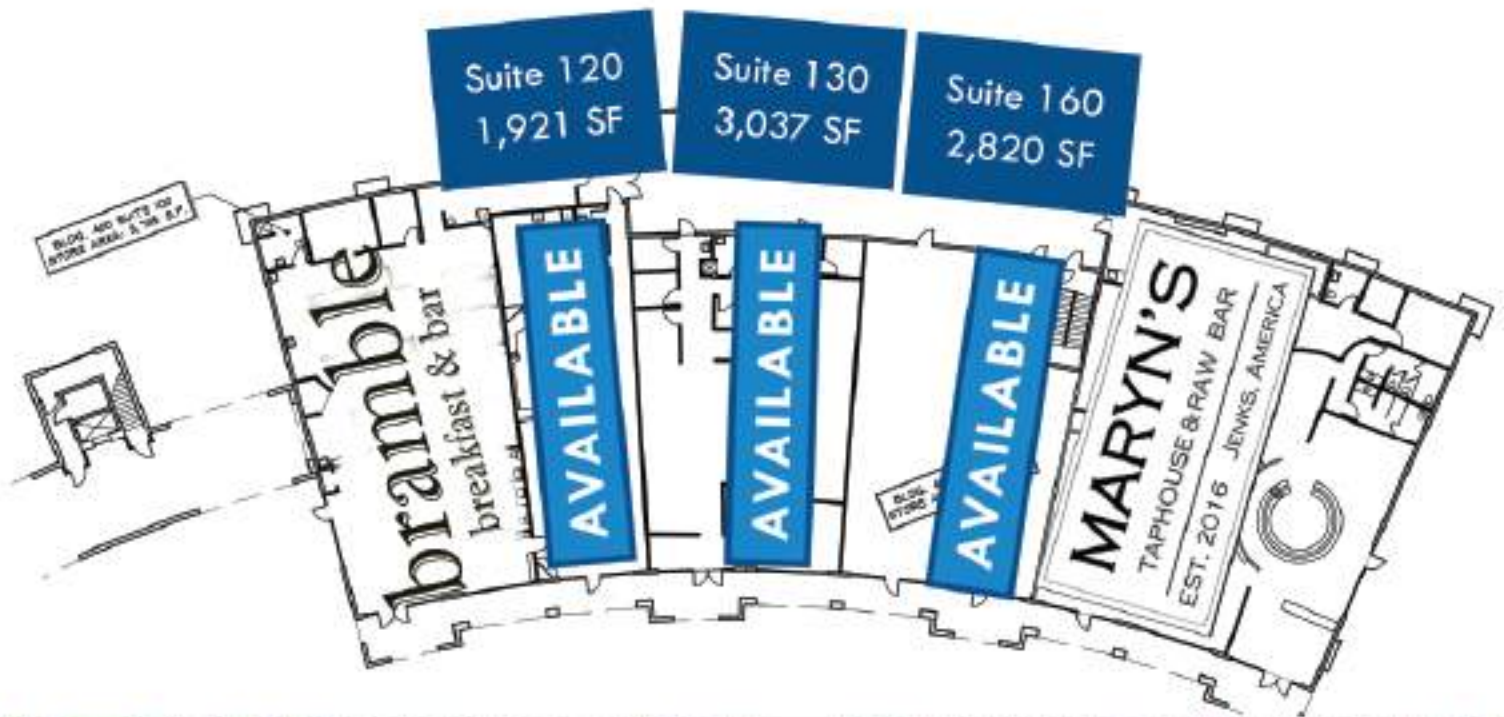

SITE PLAN BUILDING 400

FOR MORE INFORMATION:

Matt Mardis
Principal, Paine & Associates
918-481-5380 ext.13
matt@paine-associates.com

Garrett Mahoney
Partner, Paine & Associates
918-481-5380 ext.11
garrett@paine-associates.com

Brian Paine
Principal, Paine & Associates
918-481-5380 ext.12
brian@paine-associates.com

PAINE
COMMERCIAL REAL ESTATE
paine-associates.com

RIVERWALK CROSSING

400 - 1100 Riverwalk | Jenks, OK 74037



SITE PLAN BUILDING 500

FOR MORE INFORMATION:

Matt Mardis
Principal, Paine & Associates
918-481-5380 ext.13
matt@paine-associates.com

Garrett Mahoney
Partner, Paine & Associates
918-481-5380 ext.11
garrett@paine-associates.com

Brian Paine
Principal, Paine & Associates
918-481-5380 ext.12
brian@paine-associates.com



PAINE
COMMERCIAL REAL ESTATE
paine-associates.com

RIVERWALK CROSSING

400 - 1100 Riverwalk | Jenks, OK 74037



BLDG 300
SECOND FLOOR

BLDG 400
SECOND FLOOR



BLDG 600



BLDG 1000
SECOND FLOOR

BLDG 1100
SECOND FLOOR



BLDG 300
FIRST FLOOR

BLDG 400
FIRST FLOOR



BLDG 500



BLDG 1000
FIRST FLOOR



BLDG 1100
FIRST FLOOR



SITE PLANS

FOR MORE INFORMATION:

Matt Mardis
Principal, Paine & Associates
918-481-5380 ext.13
matt@paine-associates.com

Garrett Mahaney
Partner, Paine & Associates
918-481-5380 ext.11
garrett@paine-associates.com

Brian Paine
Principal, Paine & Associates
918-481-5380 ext.12
brian@paine-associates.com



PAINE

COMMERCIAL REAL ESTATE

paine-associates.com

RIVERWALK CROSSING

400 - 1100 Riverwalk | Jenks, OK 74037



TRAFFIC GENERATOR

FOR MORE INFORMATION:

Matt Mardis
Principal, Paine & Associates
918-481-5380 ext.13
matt@paine-associates.com

Garrett Mahoney
Partner, Paine & Associates
918-481-5380 ext.11
garrett@paine-associates.com

Brian Paine
Principal, Paine & Associates
918-481-5380 ext.12
brian@paine-associates.com



PAINE

COMMERCIAL REAL ESTATE

paine-associates.com

RIVERWALK CROSSING

400 - 1100 Riverwalk | Jenks, OK 74037



AERIAL

FOR MORE INFORMATION:

Matt Mardis
Principal, Paine & Associates
918-481-5380 ext.13
matt@paine-associates.com

Garrett Mahoney
Partner, Paine & Associates
918-481-5380 ext.11
garrett@paine-associates.com

Brian Paine
Principal, Paine & Associates
918-481-5380 ext.12
brian@paine-associates.com



PAINE

COMMERCIAL REAL ESTATE

paine-associates.com

RIVERWALK CROSSING

400 - 1100 Riverwalk | Jenks, OK 74037



FOR MORE INFORMATION:

Matt Mardis
Principal, Paine & Associates
918-481-5380 ext.13
matt@paine-associates.com

Garrett Mahoney
Partner, Paine & Associates
918-481-5380 ext.11
garrett@paine-associates.com

Brian Paine
Principal, Paine & Associates
918-481-5380 ext.12
brian@paine-associates.com



RIVERWALK CROSSING

400 - 1100 Riverwalk | Jenks, OK 74037



FOR MORE INFORMATION:

Matt Mardis
Principal, Paine & Associates
918-481-5380 ext.13
matt@paine-associates.com

Garrett Mahoney
Partner, Paine & Associates
918-481-5380 ext.11
garrett@paine-associates.com

Brian Paine
Principal, Paine & Associates
918-481-5380 ext.12
brian@paine-associates.com



PAINE

COMMERCIAL REAL ESTATE

paine-associates.com