



THE SHOPS AT BROOKOVER CORNER | RETAIL SPACE FOR LEASE

Adjacent to Saint Francis Health System (State's Largest Health System)
NE Corner 151st & Highway 75 Glenpool, OK 74033

FOR MORE INFORMATION:

Matt Mardis
Principal, Paine & Associates
918-481-5380 ext.13
matt@paine-associates.com

Garrett Mahaney
Principal, Paine & Associates
918-481-5380 ext.11
garrett@paine-associates.com

Brian Paine
Principal, Paine & Associates
918-481-5380 ext.12
brian@paine-associates.com

Phillips Breckinridge
Sales Associate, Paine & Associates
918-629-6489
phillips@paine-associates.com



PROJECT OVERVIEW

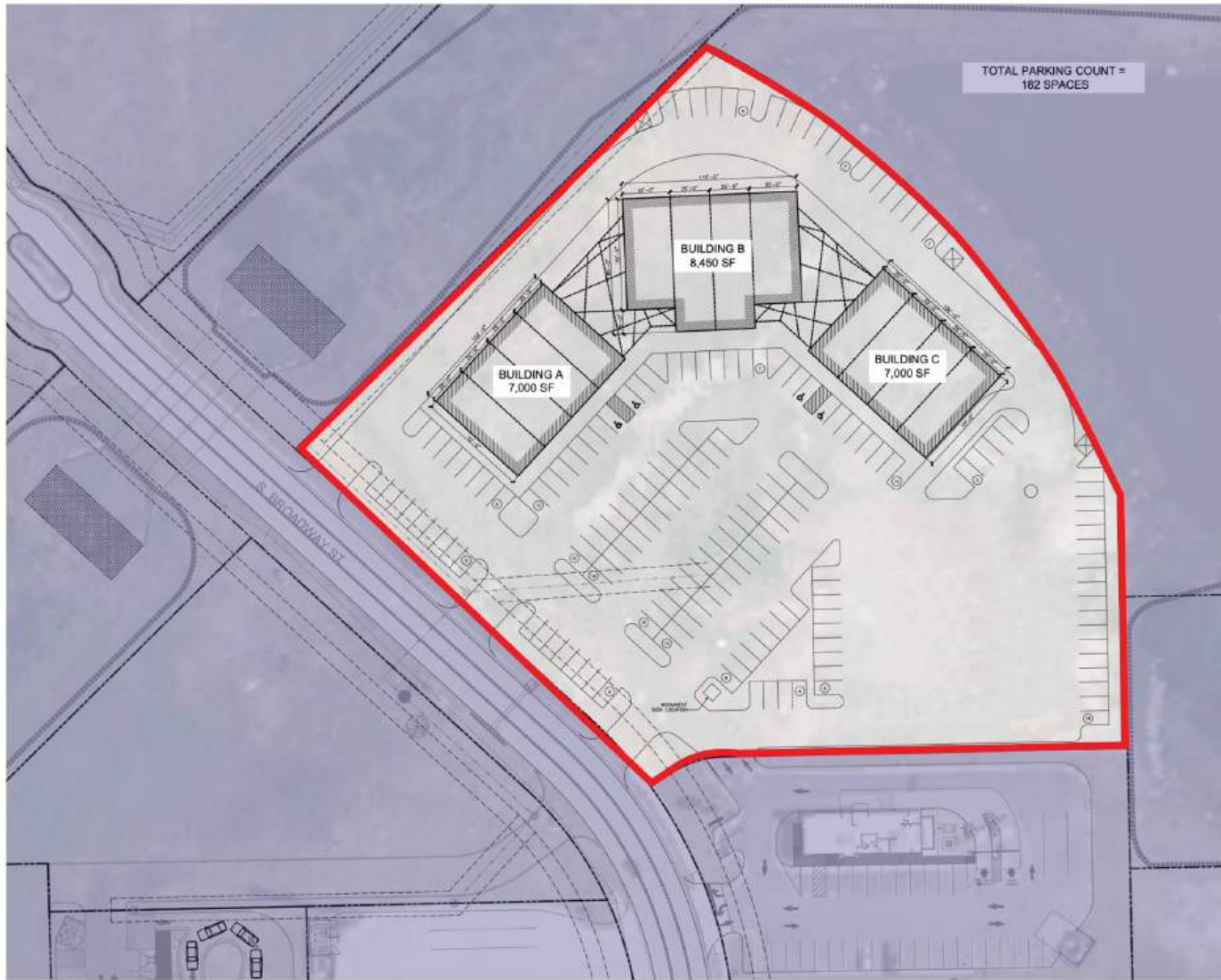

LOCATION NE Corner 151st & Highway 75
Glenpool, OK 74033

RETAIL SPACE FOR LEASE

7,000 SF Building A
8,450 SF Building B
7,000 SF Building C

22,450 SF Total Leasable Area
EST. DELIVERY 2025

PRICE \$35 PSF \$5 NNN

HIGHLIGHTS

- Surrounded by New & Planned Residential Development
- Outstanding Visibility from Major Arterial Roads
- Pylon Signage

JOIN

ARVEST
BRAUM'S
CASEY'S
TACO BELL
OKLAHOMA FEDERAL CREDIT UNION
SAME DAY AUTO REPAIR
SHERWIN WILLIAMS

Adjacent to Saint Francis, the State's Largest Health System

(\$23 MILLION FACILITY)

VIEW VIDEO TOUR

FOR MORE INFORMATION:

Matt Mardis
Principal, Paine & Associates
918-481-5380 ext.13
matt@paine-associates.com

Garrett Mahaney
Principal, Paine & Associates
918-481-5380 ext.11
garrett@paine-associates.com

Brian Paine
Principal, Paine & Associates
918-481-5380 ext.12
brian@paine-associates.com

Phillips Breckinridge
Sales Associate, Paine & Associates
918-629-6489
phillips@paine-associates.com



SITE PLAN



AERIAL



TRAFFIC COUNTS
39,400 CPD US HIGHWAY 75
11,300 CPD 151ST ST. SOUTH/
HIGHWAY 67

3 WAY STOP



NEW ROAD (BROADWAY)

SHOPS



2 WAY ACCESS ROAD (S. CASPER ST. W.)

NEW TRAFFIC SIGNALS WITH TURN LANES



MOAB DEVELOPMENT COMMERCIAL REAL ESTATE
P A I N E
paine-associates.com

PROJECT ELEVATIONS



FOR MORE INFORMATION:

Matt Mardis
Principal, Paine & Associates
918-481-5380 ext.13
matt@paine-associates.com

Garrett Mahaney
Principal, Paine & Associates
918-481-5380 ext.11
garrett@paine-associates.com

Brian Paine
Principal, Paine & Associates
918-481-5380 ext.12
brian@paine-associates.com

Phillips Breckinridge
Sales Associate, Paine & Associates
918-629-6489
phillips@paine-associates.com

