



THE SHOPS AT ADAMS CREEK

BROKEN ARROW RETAIL DEVELOPMENT

REGIONAL POWER CENTER Anchored by TARGET, LOWES, & CINEMARK
 E. Hillside Drive @ N. 23rd Street Broken Arrow, OK 74012

FOR MORE INFORMATION:

Matt Mardis
 Principal, Paine & Associates
 918-481-5380 ext.13
matt@paine-associates.com

Garrett Mahaney
 Principal, Paine & Associates
 918-481-5380 ext.11
garrett@paine-associates.com

Brian Paine
 Principal, Paine & Associates
 918-481-5380 ext.12
brian@paine-associates.com

Phillips Breckinridge
 Sales Associate, Paine & Associates
 918-629-6489
phillips@paine-associates.com



PROJECT OVERVIEW



LOCATION E. Hillside Dr. at N. 23rd St.
Broken Arrow, OK 74012

SIZE 22.20 Acres, ZONING: C5

- 3,500 SF Shops
- 3,540 SF Suite 2030
- 4,524 SF End-Cap
- 3,500-7,000 SF Restaurant

DELIVERY Warm shell, HVAC, plumbing, electrical, leave-out, grease traps (on end-caps sized to suit.)

RATE \$39.00 PSF NNN

PROPOSED TENANT LINEUP

Burlington's
Five Below
Shoe Department | Encore
Books A Million
Pet Supplies Plus
Bealls
Kids Empire
Goldfish Swim School
Catrina Fresh

HIGHLIGHTS

Regional Power Center, Excellent Demographics, Pylon Signage

TRAFFIC COUNTS

18,677 CPD County Line Road
25,700 CPD E. Kenosha Street
63,400 CPD B.A. Expressway

Over 6.2 Million Visits 2021 (*Placer.ai)

TRADE AREA

TARGET | LOWE'S | CINEMARK | DICKS SPORTING GOODS | MARSHALLS | AT&T | PETSMART | ULTA | MAURICES | T-MOBILE | US CELLULAR | ROSS | ASPEN DENTAL | MICHAELS | FAMOUS FOOTWEAR | OLIVE GARDEN | FIVE GUYS | PANDA EXPRESS | CHICKEN SALAD CHICK | SLIM CHICKENS | FREDDY'S FROZEN CUSTARD | CRUMBL COOKIES | SHAWARMA SHACK | CASA TEQUILA MEXICAN KITCHEN | IHOP | SANTA FE CATTLE | PIZZA HUT | BUFFALO WILD WINGS | HIBDON TIRES | CHILIS | GALLERIA FURNITURE & MORE | PIZZA HUT | SCOOTERS COFFEE | QUIK TRIP | WENDYS | LIFE CHURCH | WHATABURGER | SONIC



PROJECT ELEVATIONS



2 PROPOSED OVERALL BUILDING ELEVATION
SCALE NTS

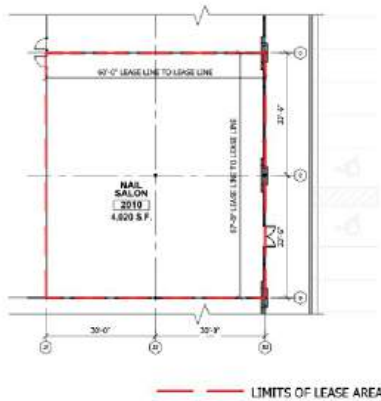

1 LOD FLOOR PLAN
SCALE 1/8" = 1'-0"

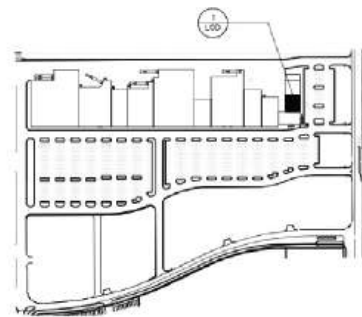

3 KEY PLAN
SCALE NTS

FOR MORE INFORMATION:

Matt Mardis
Principal, Paine & Associates
918-481-5380 ext.13
matt@paine-associates.com

Garrett Mahaney
Principal, Paine & Associates
918-481-5380 ext.11
garrett@paine-associates.com

Brian Paine
Principal, Paine & Associates
918-481-5380 ext.12
brian@paine-associates.com

Phillips Breckinridge
Sales Associate, Paine & Associates
918-629-6489
phillips@paine-associates.com

